

BOM on next Page
 item no.s on this page refer to BOM
 e.g. item (2) is the CCW tine (2011057C0)

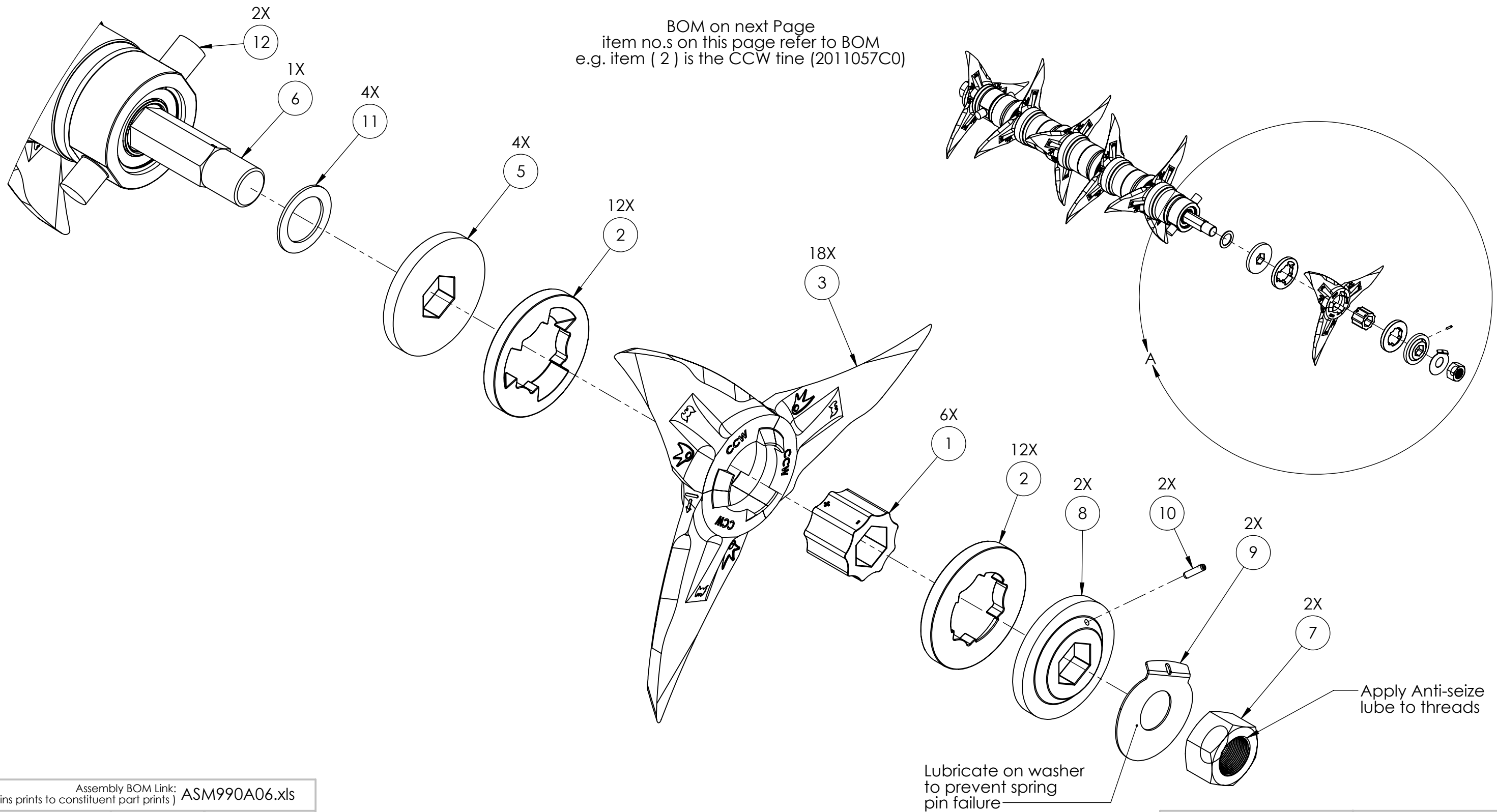

DETAIL A
 SCALE 1 : 4

Assembly BOM Link:
 (contains prints to constituent part prints) [ASM990A06.xls](#)

Drawing Name: ASM990A06	REVISION 0	DATE 3/26/2016
A:	DEBUR AND BREAK SHARP EDGES	
B:	UNLESS OTHERWISE SPECIFIED: DIMENSIONS ARE IN INCHES SURFACE FINISH: TOLERANCES: LINEAR: 1/32" ANGULAR: .1°	
C:	DO NOT SCALE DRAWING	
D:	B	SCALE:1:16
E:	SHEET 1 OF 5	
NAME Daniel R. M.	SIGNATURE	

PART NO. ASM990A06	DESCRIPTION: 6star roller, CCW
PROCESSES Assemble Grease	WEIGHT: 385.49Lbs
Soil Regeneration Unlimited	
<small>PROPRIETARY AND CONFIDENTIAL THE INFORMATION CONTAINED IN THIS DRAWING IS THE SOLE PROPERTY OF SOIL REGENERATION UNLIMITED. ANY REPRODUCTION IN PART OR AS A WHOLE WITHOUT THE WRITTEN PERMISSION OF SOIL REGENERATION UNLIMITED IS PROHIBITED.</small>	

ITEM NO.	PartNo	QTY.	Weight	Description	Material
1	2011012C0	6	2.49	ROLLER HARTING RING DRIVER	80-55-06
2	2011018C1	12	2.37	Harting Ring, Cast	80-55-06
3	2011057C0	18	4.883	CCW Tine, Tabs Base, hard-faced	2011013C2
4	2011074C1	8	20.96	Short Spacer, Cast	65-45-12
5	2011085C0	4	3.50	End Cap	80-55-06
6	2011088C3	1	42.86	Arbor Bolt, 6star	BAR HEX-1.75 4140 ANLD
7	2011185P0	2	1.60	1-3/4"-12 Grade 8 Hex Nut	Grade 8 Steel
8	2012180C1	2	3.49	End Cap, drilled	2011085C0
9	2012182C1	2	0.27	Roller nut lock flange	SH-14GA
10	2012184P1	2	0.008	1/4" x 1" Zinc-Plated Steel Slotted Spring Pin, MCM# 90692A742	MCM# 90692A742
11	2014183P0	4	0.13	Flat roller bearing washer, BOKERS# 422395	BOKERS# 422395
12	ASM986A04	2	9.23	Roller Bearing Unit	

Assembly BOM Link: (contains prints to constituent part prints)		.xls	
Drawing Name: ASM990A06	REVISION DATE 3/26/2016		
A:			
B:	DEBUR AND BREAK SHARP EDGES		
C:	UNLESS OTHERWISE SPECIFIED: DIMENSIONS ARE IN INCHES SURFACE FINISH: TOLERANCES: LINEAR: 1/32" ANGULAR: .1°		
D:			
E:	DO NOT SCALE DRAWING		
NAME Daniel R. M.	SIGNATURE	B	SCALE:1:16
SHEET 2 OF 5			

PART NO.	DESCRIPTION:
PROCESSES	WEIGHT:
	Soil Regeneration Unlimited
	PROPRIETARY AND CONFIDENTIAL THE INFORMATION CONTAINED IN THIS DRAWING IS THE SOLE PROPERTY OF SOIL REGENERATION UNLIMITED. ANY REPRODUCTION IN PART OR AS A WHOLE WITHOUT THE WRITTEN PERMISSION OF SOIL REGENERATION UNLIMITED IS PROHIBITED.

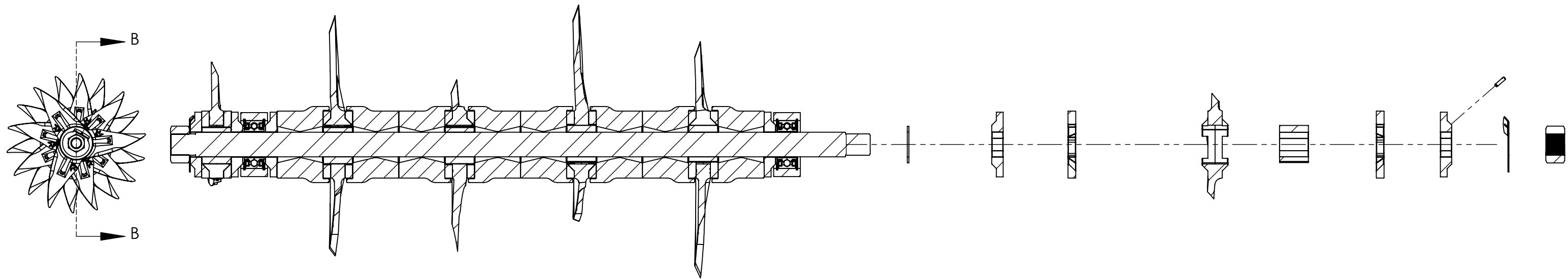

SECTION B-B
SCALE 1 : 8

Assembly BOM Link:
(contains prints to constituent part prints) [ASM990A06.xls](#)

Drawing Name: ASM990A06
REVISION 0
DATE 3/26/2016

A:
B:
C:
D:
E:

DEBUR AND BREAK SHARP EDGES
UNLESS OTHERWISE SPECIFIED:
DIMENSIONS ARE IN INCHES
SURFACE FINISH:
TOLERANCES:
LINEAR: 1/32"
ANGULAR: .1°

DO NOT SCALE DRAWING

NAME Daniel R. M. SIGNATURE

B SCALE:1:16

SHEET 3 OF 5

PART NO. ASM990A06	DESCRIPTION: 6star roller, CCW
PROCESSES	WEIGHT: 385.49lbs
Assemble	Soil Regeneration Unlimited
Grease	
	PROPRIETARY AND CONFIDENTIAL THE INFORMATION CONTAINED IN THIS DRAWING IS THE SOLE PROPERTY OF SOIL REGENERATION UNLIMITED. ANY REPRODUCTION IN PART OR AS A WHOLE WITHOUT THE WRITTEN PERMISSION OF SOIL REGENERATION UNLIMITED IS PROHIBITED.

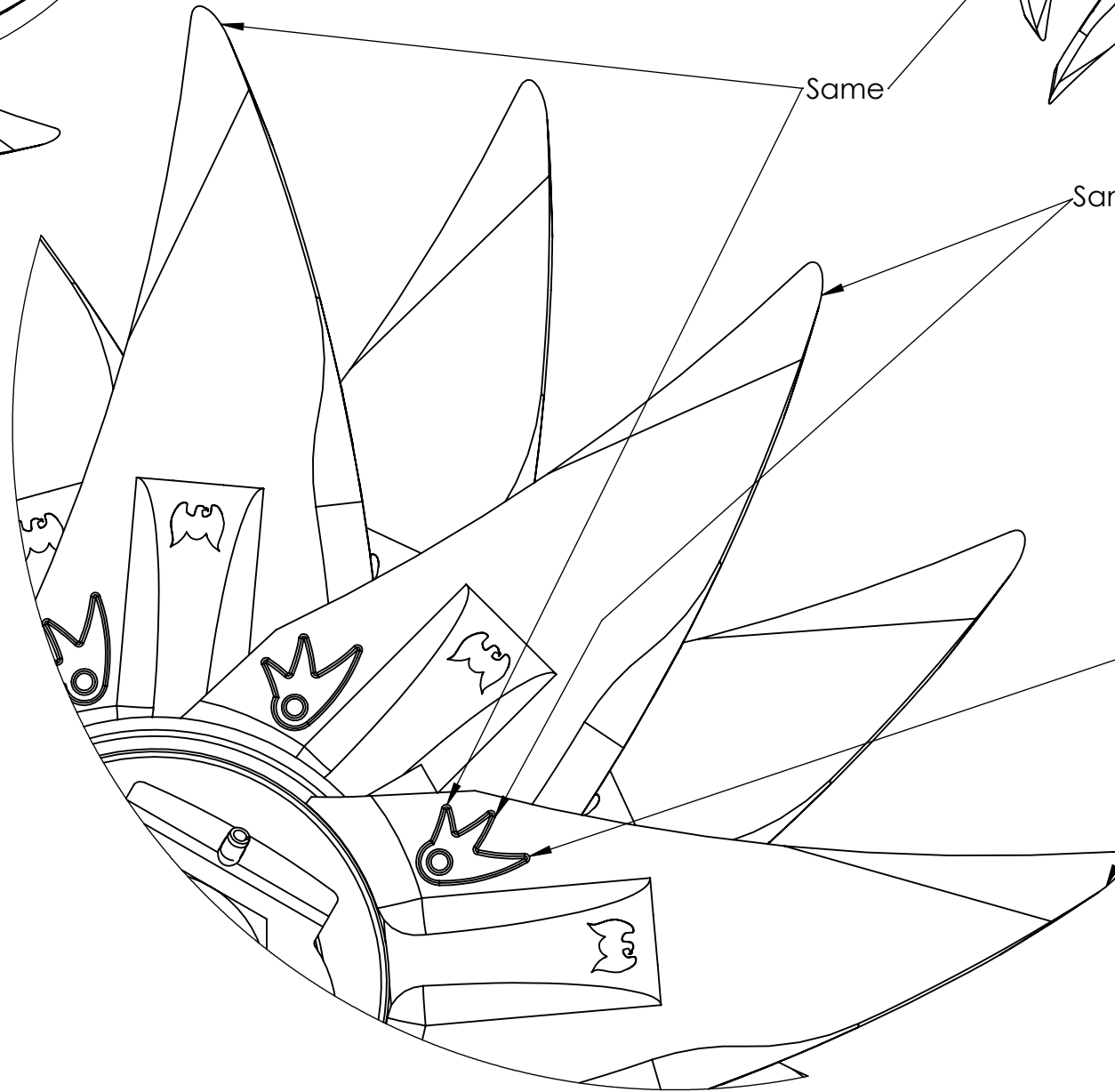
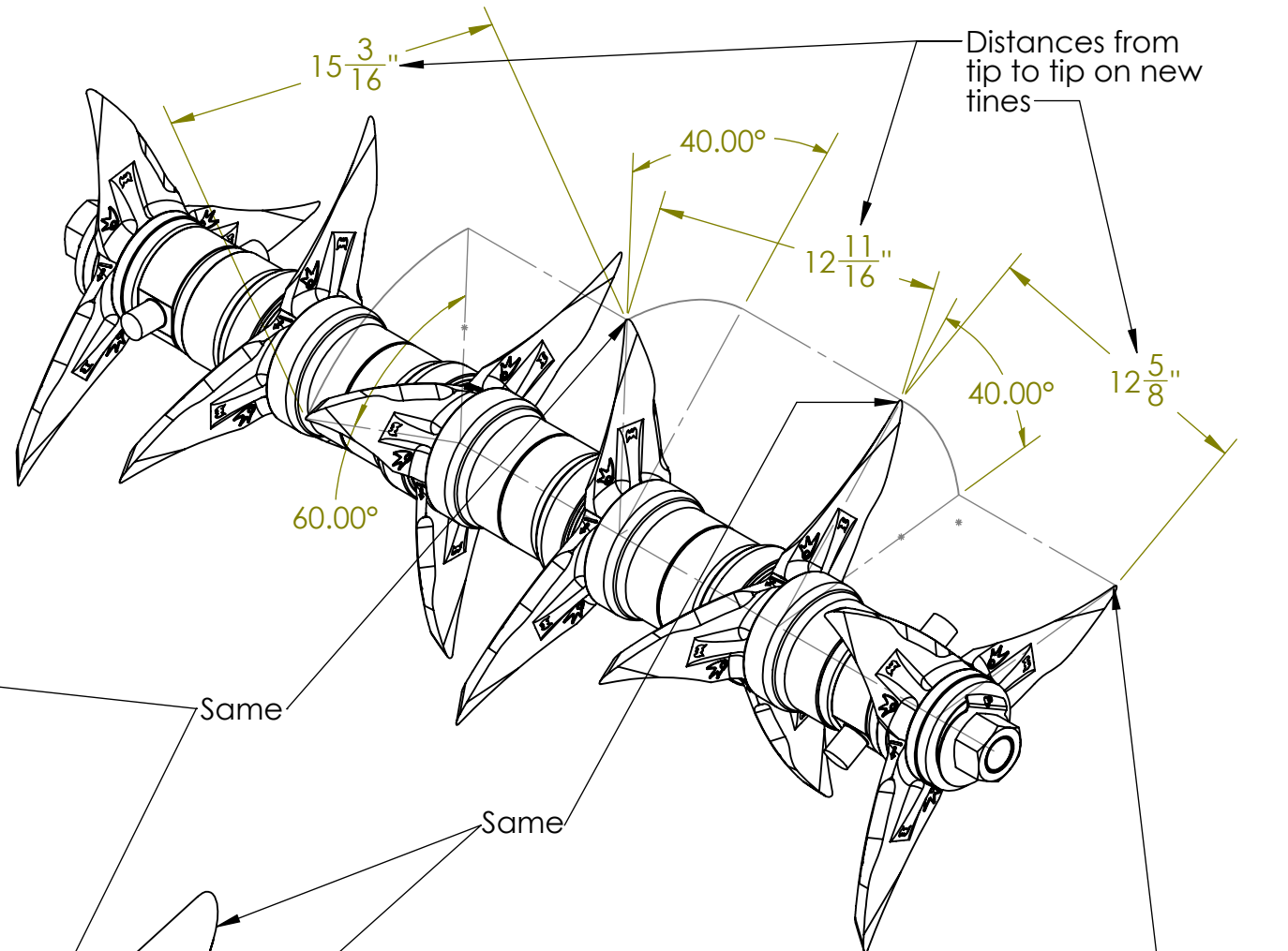
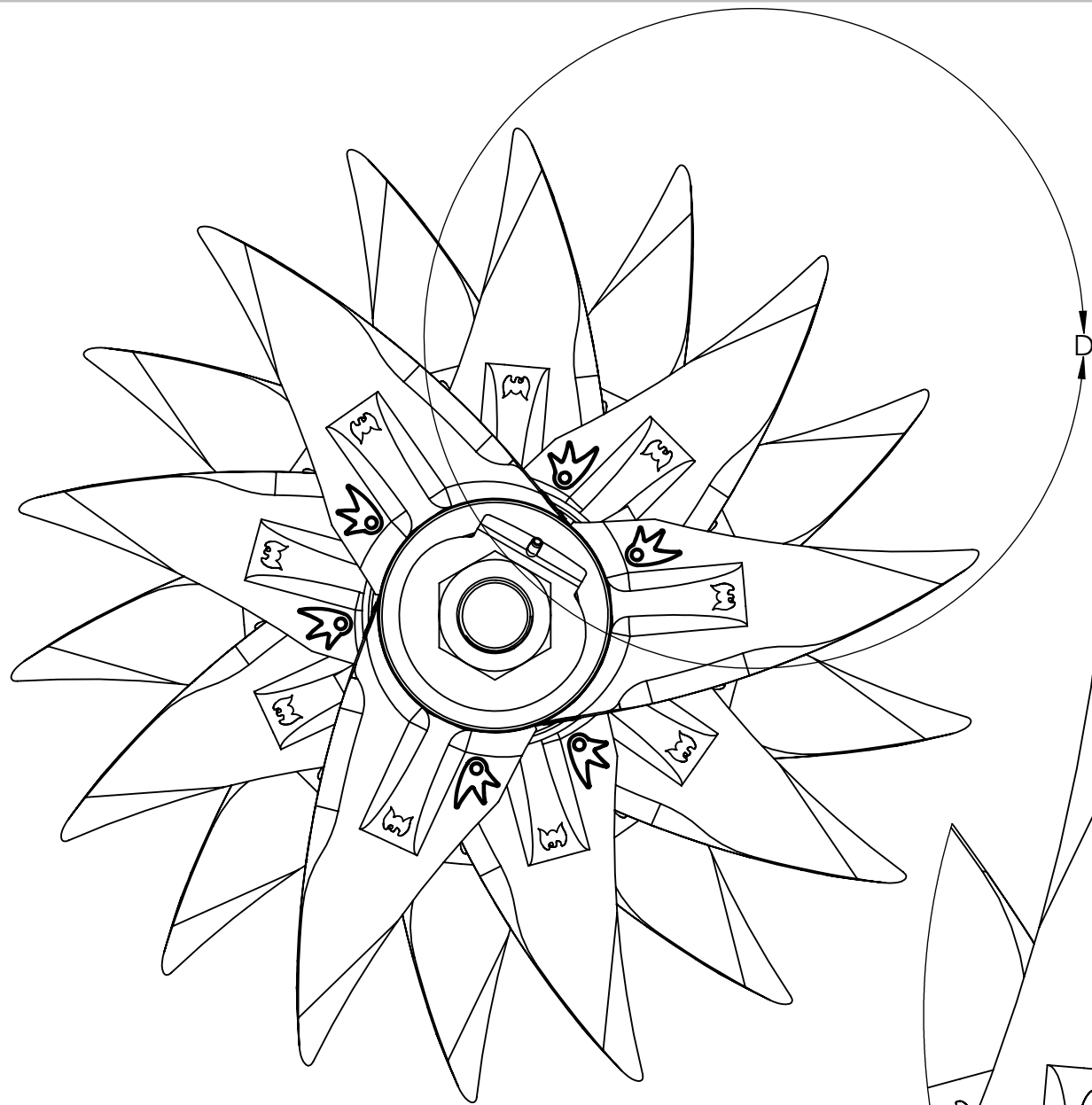

DETAIL D
SCALE 1 : 2

Assembly BOM Link: [ASM990A06.xls](#)
(contains prints to constituent part prints)

Drawing Name: ASM990A06	REVISION 0 DATE 3/26/2016
A:	
B:	
C:	
D:	
E:	

DEBUR AND BREAK SHARP EDGES
UNLESS OTHERWISE SPECIFIED:
DIMENSIONS ARE IN INCHES
SURFACE FINISH:
TOLERANCES:
LINEAR: 1/32"
ANGULAR: .1°

DO NOT SCALE DRAWING

B SCALE:1:4

NAME Daniel R. M. SIGNATURE

SHEET 4 OF 5

PART NO. ASM990A06	DESCRIPTION: 6star roller, CCW
PROCESSES Assemble Grease	WEIGHT: 385.49Lbs
	Soil Regeneration Unlimited
	PROPRIETARY AND CONFIDENTIAL THE INFORMATION CONTAINED IN THIS DRAWING IS THE SOLE PROPERTY OF SOIL REGENERATION UNLIMITED. ANY REPRODUCTION IN PART OR AS A WHOLE WITHOUT THE WRITTEN PERMISSION OF SOIL REGENERATION UNLIMITED IS PROHIBITED.

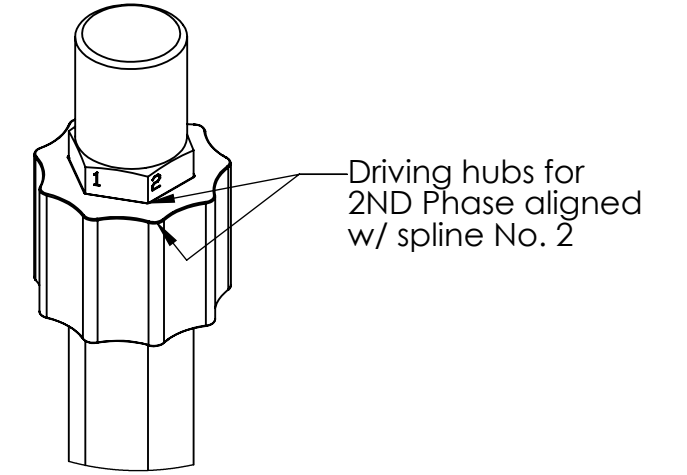
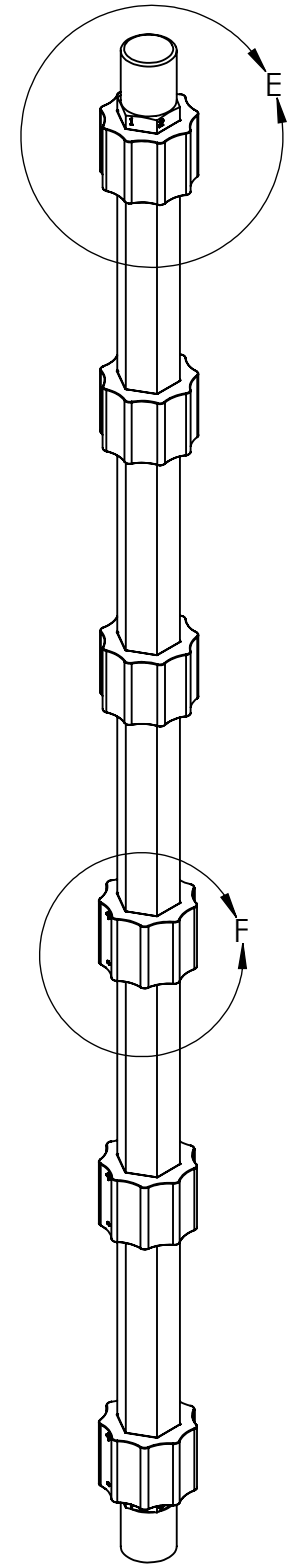
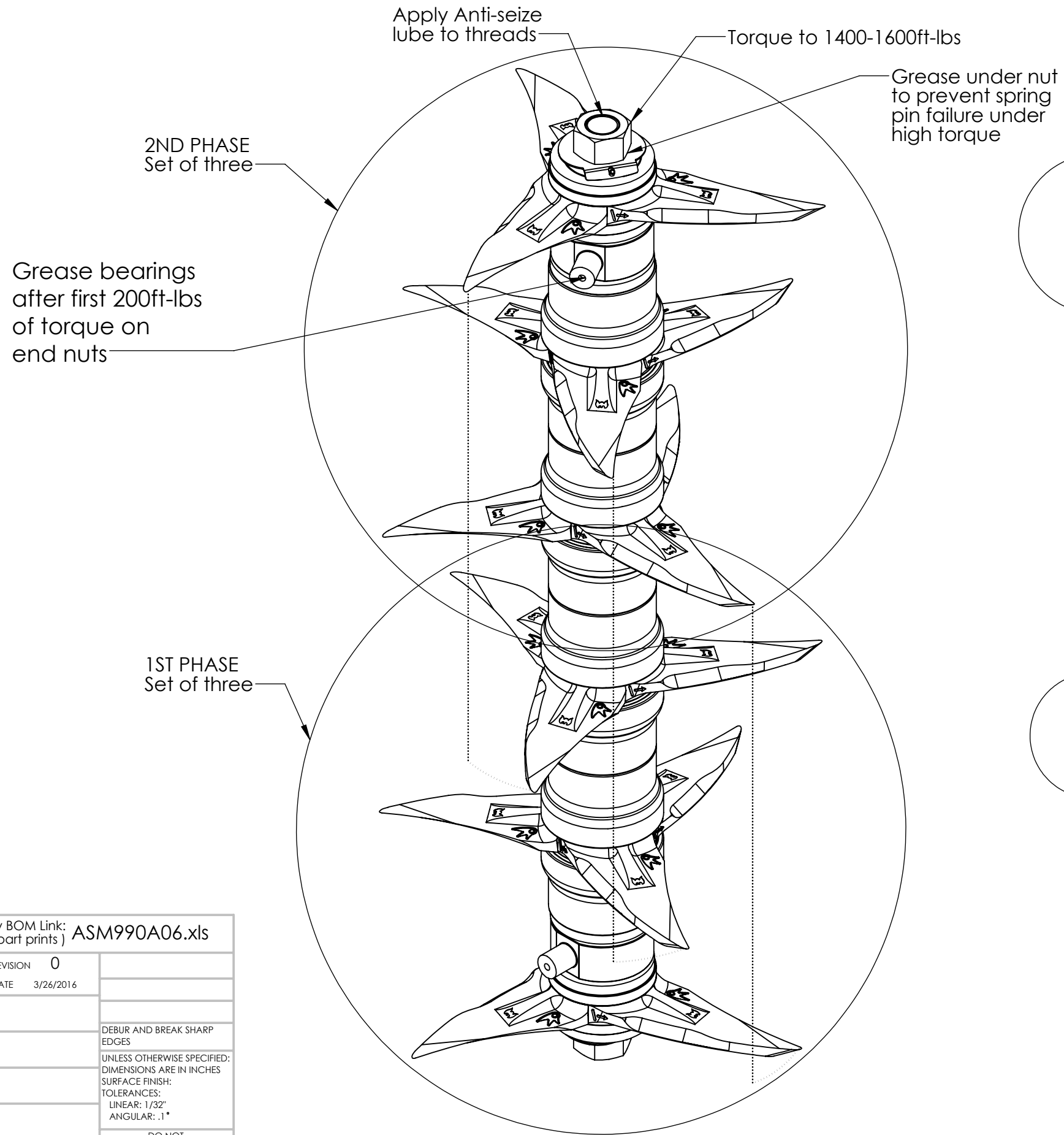

DETAIL E
SCALE 1 : 3

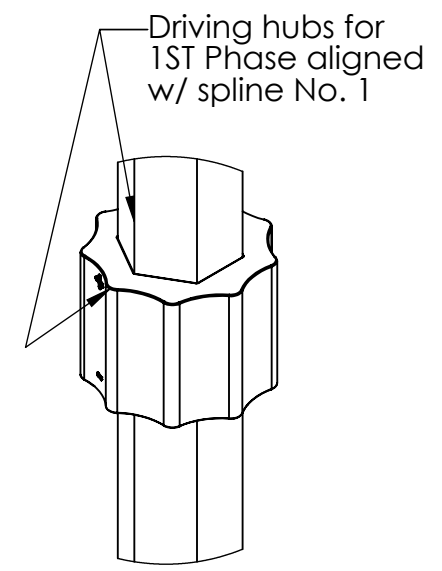

DETAIL F
SCALE 1 : 3

Assembly BOM Link: (contains prints to constituent part prints) ASM990A06.xls	
Drawing Name: ASM990A06	REVISION 0 DATE 3/26/2016
A:	DEBUR AND BREAK SHARP EDGES UNLESS OTHERWISE SPECIFIED: DIMENSIONS ARE IN INCHES SURFACE FINISH: TOLERANCES: LINEAR: 1/32" ANGULAR: .1°
B:	
C:	
D:	
E:	
NAME Daniel R. M.	SIGNATURE
DO NOT SCALE DRAWING	
B SCALE:1:6	
SHEET 5 OF 5	

PART NO. ASM990A06	DESCRIPTION: 6star roller, CCW
PROCESSES	WEIGHT: 385.49Lbs
Assemble	Soil Regeneration Unlimited
Grease	
<small>PROPRIETARY AND CONFIDENTIAL THE INFORMATION CONTAINED IN THIS DRAWING IS THE SOLE PROPERTY OF SOIL REGENERATION UNLIMITED. ANY REPRODUCTION IN PART OR AS A WHOLE WITHOUT THE WRITTEN PERMISSION OF SOIL REGENERATION UNLIMITED IS PROHIBITED.</small>	