

ITEM NO.	PartNo	QTY.	Weight	Description	Material	Length
1	2011189P0	2	0.184	1"-14 Zinc-Plated Grade 5 Steel Thin Hex Nut, MCM# 94846A555	MCM# 94846A555	
2	2011190P0	1	0.31	1"-8 Oval Locknut with Conical Top, Cadmium-Plated Grade C Steel, MCM# 92501A462	MCM# 92501A462	
3	2011199P0	1	0.02	FLAT WASHER, .5, SAE, McMaster: 98023A33	SAE WASHER	
4	2011213P2	2	0.038	3/8" X 2 Slotted spring pin ZP, MCM# 90692A775	MCM# 90692A775	
5	2011216P0	1	0.006	Steel Grease Fitting Straight, 1/4"-28 Taper Male, 33/64" Overall Height, MCM# 1095K41	MCM# 1095K41	
6	2011237P1	2	0.04	.148" x 3-5/16", 3/4" Eye, Fits 3/4"-1-1/8" Shaft, Zinc-Plated Steel Hairpin, MCM# 98335A085	MCM# 98335A085	
7	2011241P0	1	0.37	1/2"-13 x 6" Gr.5 HHCS ZP, MCM# 91247A736	MCM# 91247A736	
8	2011251P0	1	0.039	1/2"- 13 Zinc Plated Grade 5 Steel Hex Nut, MCM# 95462A033	MCM# 95462A033	
9	2011275C4	2	0.441	Set pin, harw offset angle		
10	2011367P0	1	0.027	1/2"-13 Zinc-Plated Grade 5 Steel Thin Hex Nut , 3/4" Width, 5/16" Height, MCM# 94846A523	MCM# 94846A523	
11	2012055C1	1	1.69	Harw Level adjust T-bolt		
12	2012229C6	1	134.324	Harw control mainframe, single module		
13	2012279C4	1	23.232	Harw backbone hinge brkt		
14	2014009P0	1	1.688	1-8" x 6-1/2" HHCS Gr.5 ZP, MCM# 91247A929	MCM# 91247A929	6.5
15	2014122C0	2	0.027	UHMW bushing, Harw hinge	TS-1.0 DIA x .125 UHMW	2
16	2014154P0	2	0.660	1/2"-13 x 1-1/2", 3" x 4-1/2", Square U-bolt, ASC# 73130	ASC# 73130	12.3992
17	2015066P0	4	0.06	1/2"-13 Flange Top-lock hex nut Gr.5 BLK Phos, MCM# 90949A037	MCM# 90949A037	
18	A321R0	1	0.001	(Grease Gun) 50 graphic	PLASTIC	0.01
19	A323R0	2	0.000	Pinch point graphic	PLASTIC	0.01
20	ASM979A08	1	53.79	Harw module hanger, finished		
21	B032R0	2	1.23	1" x 5-3/4" single hole pin	BAR-1 DIA C1045	5.75
22	B987R0	2	0.013	Harrow angle scale	PLASTIC	0.01

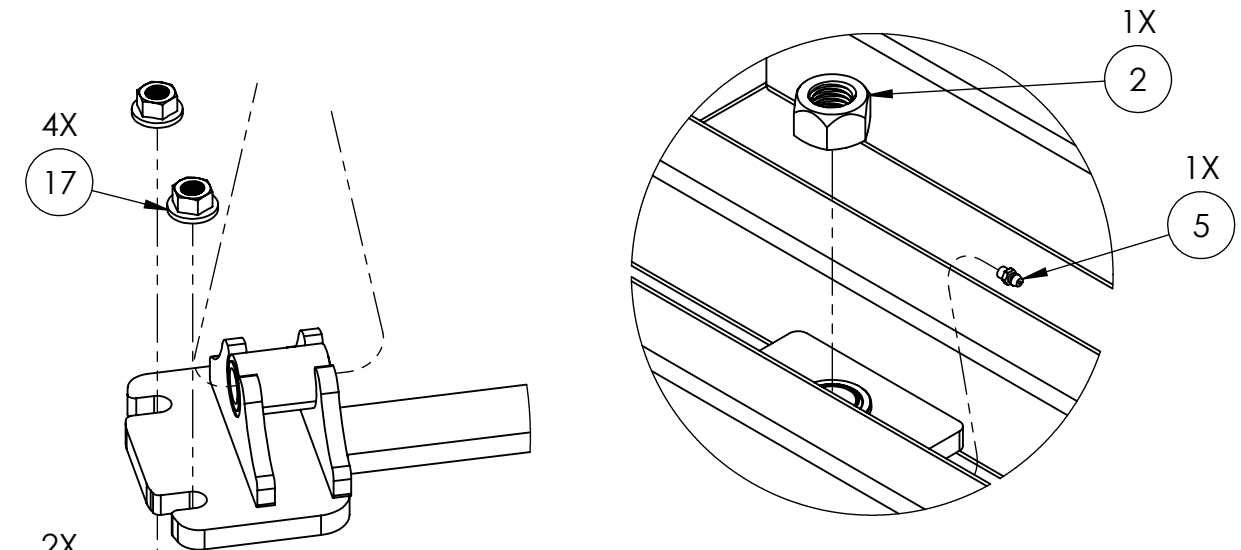

DETAIL A
SCALE 1 : 4

DETAIL B
SCALE 1 : 4

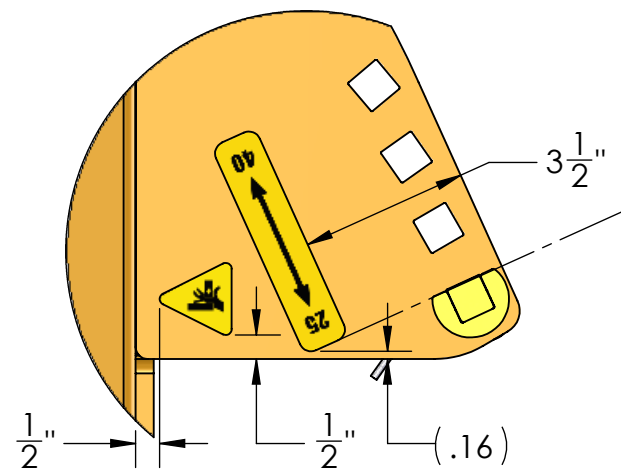

Assembly BOM Link: [ASM969A11.xls](#)
 (contains prints to constituent part prints)

Drawing Name: ASM969A11

REVISION 0

DATE 2/17/2016

A:

B:

C:

D:

E:

DEBUR AND BREAK SHARP EDGES

UNLESS OTHERWISE SPECIFIED:
 DIMENSIONS ARE IN INCHES
 SURFACE FINISH:
 TOLERANCES:
 LINEAR: 1/16"
 ANGULAR: 2°

DO NOT SCALE DRAWING

B SCALE:1:8

NAME Daniel R. M.

SIGNATURE

SHEET 1 OF 1

PART NO. **ASM969A11**

DESCRIPTION: Control frame assembly, Harrow modules

PROCESSES

Assemble

Grease

WEIGHT: 220.998Lbs

Soil Regeneration Unlimited

PROPRIETARY AND CONFIDENTIAL
 THE INFORMATION CONTAINED IN THIS DRAWING IS THE SOLE PROPERTY OF SOIL REGENERATION UNLIMITED. ANY REPRODUCTION IN PART OR AS A WHOLE WITHOUT THE WRITTEN PERMISSION OF SOIL REGENERATION UNLIMITED IS PROHIBITED.